

1. W109 300 SEL 1966 engine M189 VIN10901512001379
 - No engine specified for this VIN in the system, assumed engine M189.988
 - FIP PN A1890700701, cross ref with Tech Manual shows PES KL 70A 120 R19
 - There were two part numbers for this R19
 - A1890700501, replaced by
 - A1890700701 – diff: with ball check valves and no oil check valve
 - Parts list shows PN A1890700701
 - PN for seal No. 3 is A0029971440, not recognized by the system (probably NLA, need to ask Bosch service for parts), 6pcs in a pump

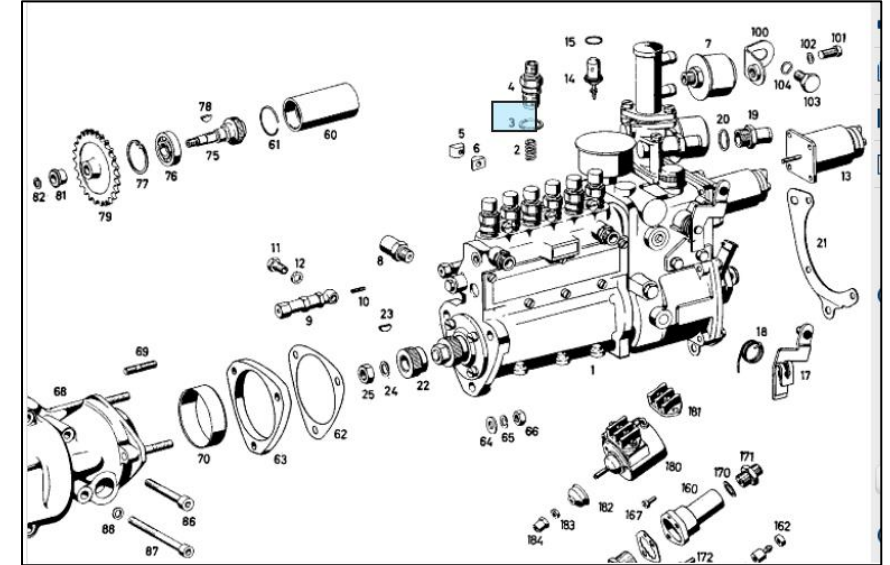

2. W109 300 SEL 1969 engine M100 VIN10901812002925
 - No engine specified for this VIN in the system, assumed engine M100.981
 - FIP PN A1000700801, cross ref with Tech Man PES KL 75/120 L17 W
 - Note: As of engine: 980 000991 ALSO INSTALLED ON 000989
 - PN for seal No. 9 is **A0019973040**, 8pcs, ca \$8, 72hrs availability

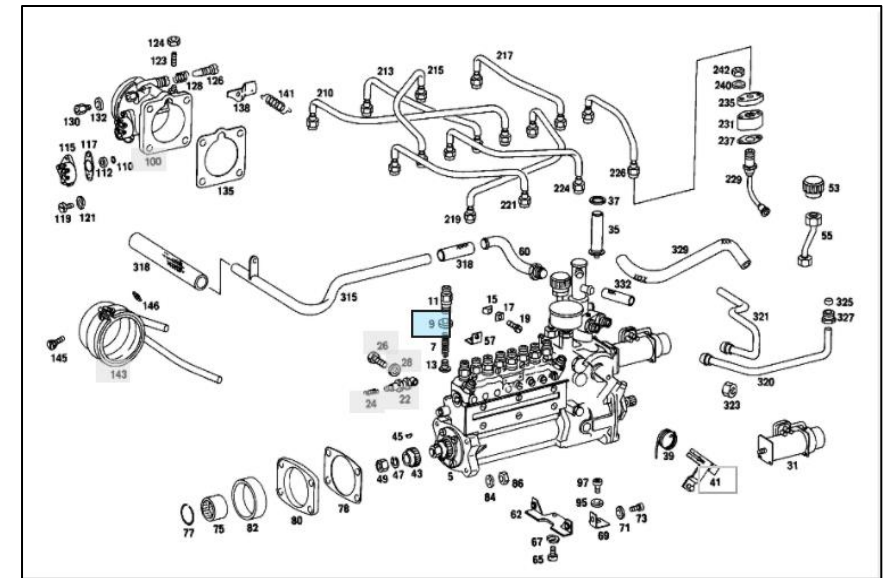

3. W111 220SEb coupe 1961 engine M127, 2 elements FIP, VIN 11102112013240, engine 12796412000001

- No engine specified for this VIN in the system
- M127964 – such number does not exist
- I am assuming you mean engine M12798412000001
- FIP PN A1270700499, A1270700801, A0040741701, A0040747201, A1270701001

Note for all: Up to engine: 982 12/52 012576 982 22/62 012870 **984 12/52,22/62 003256**

Replaced by (+bracket A 189 074 02 40)

- A1270701701
Note: As of engine: 982 12/52 012577 982 22/62 012871 984
12/52,22/62 000257 (should be 3257 here)
- I did not find cross reference for Bosch type
- PN for seal No. 33
 - A0019977440 (TO 127 070 01 99/03 99,003 074 68 01,127 070 04
99,127 070 06 01,004 074 17 01 (pre-replacement FIPS), NLA,
2pcs
 - A0019973040 (TO 127 070 05 01/09 01/16 01,004 074 13 01/72
01,127 070 08 01/17 01), 2pcs, ca \$8, 72hrs availability

4. W111 250SEb coupe 1967 engine M129.980.10.029098, VIN 11102110069115

- FIP PN A1290700301 Note: Up to engine: 980 10/20 018086 980 12/22 014781 982 10/20 000196 982 12/22 000136, replaced with
- A1290700601 Note: As of engine: 980 10/20 018087 980 12/22 014782 982 10/20 000197 982 12/22 000137
- With air pollution control A1290700801 (SA 12207 01/02 – automatic and manual)
- Bosch cross reference from Tech Manual, respectively PES 6 KL 70 A 120 R18, PES 6 KL 70 A 120 R18z and PES 6 KL 70A 120 R18y
- PN for seal No. 6 **A0019973040**, 6pcs, ca \$8, 72hrs availability
- PN for seal No. 5F A0069977845, Note: TO 129 070 06 01, NLA

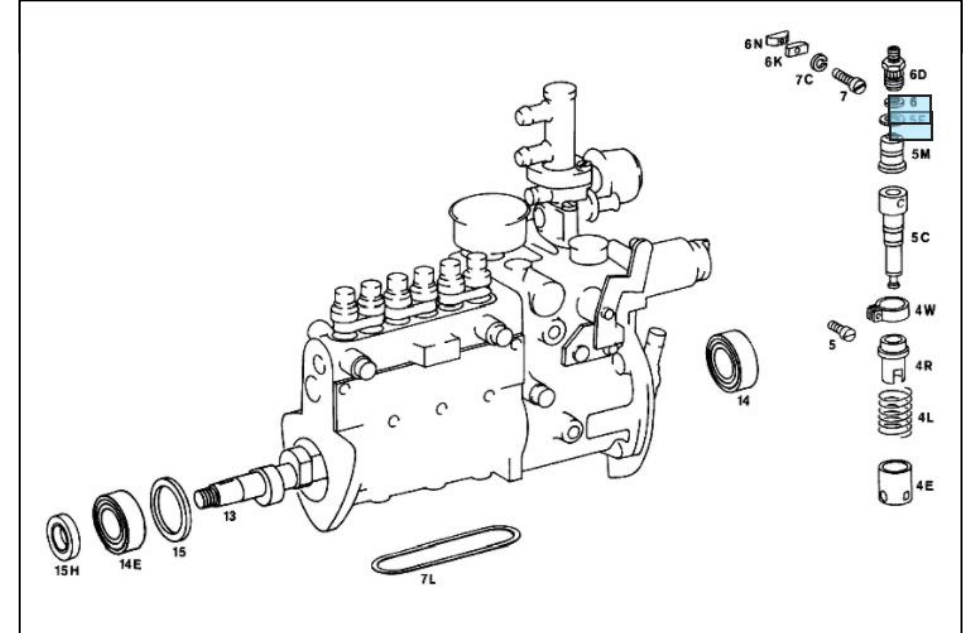
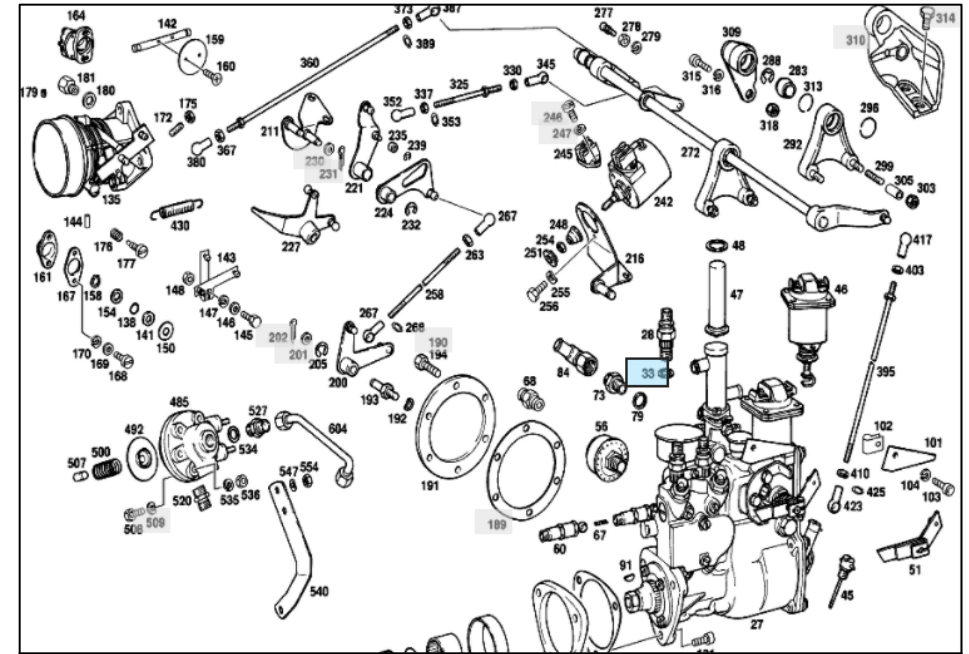

5. W112 300SEb coupe 1966, engine M189, should be same as first W109 VIN 11202112009382

- Engine not specified for this VIN in the system
- For W112021 I found M189985 or M189987
- For M189987 FIP PN A189 070 07 01 (yes, same as in W109) PES KL 70A 120 R19
- PN for seal No. 3 is A0029971440, not recognized by the system (probably NLA, need to ask Bosch service for parts), 6pcs in a pump
- For M189985 FIP PN (automatic) A1890700001 (not the same as in W109), Bosch type cross reference from Tech Manual EP/ZEB 2KL 75 R15 (difference to previous R12 – modified check valves)
- Seal PN **A0019973040**, ca \$8, 72hrs availability; it says 1pc, but I think should be 2pcs

No Picture

6. W113 280SL 1968 engine M130 VIN 11304412003550

- Engine specified for 113044 M130983
- FIP PN A1300700201, A1300702001 or PES 6 KL 70 B 120 R21, then Tech Manual says A1300701401 or PES 6 KL 70 B 120 R23 then R25
- FIP for Air Pollution A1300701101, A1300701701 or PES 6 KL 70 B 120 R20Y, PES 6 KL 70 B 120 R 22Y, and R24Y
- PN seal No. 24 **A0019973040**, 6pcs, ca \$8, 72hrs availability (for all those FIPs)

