

Disassembly, Checking, Repair, and Reassembly of Power Steering

Job No.

46-27

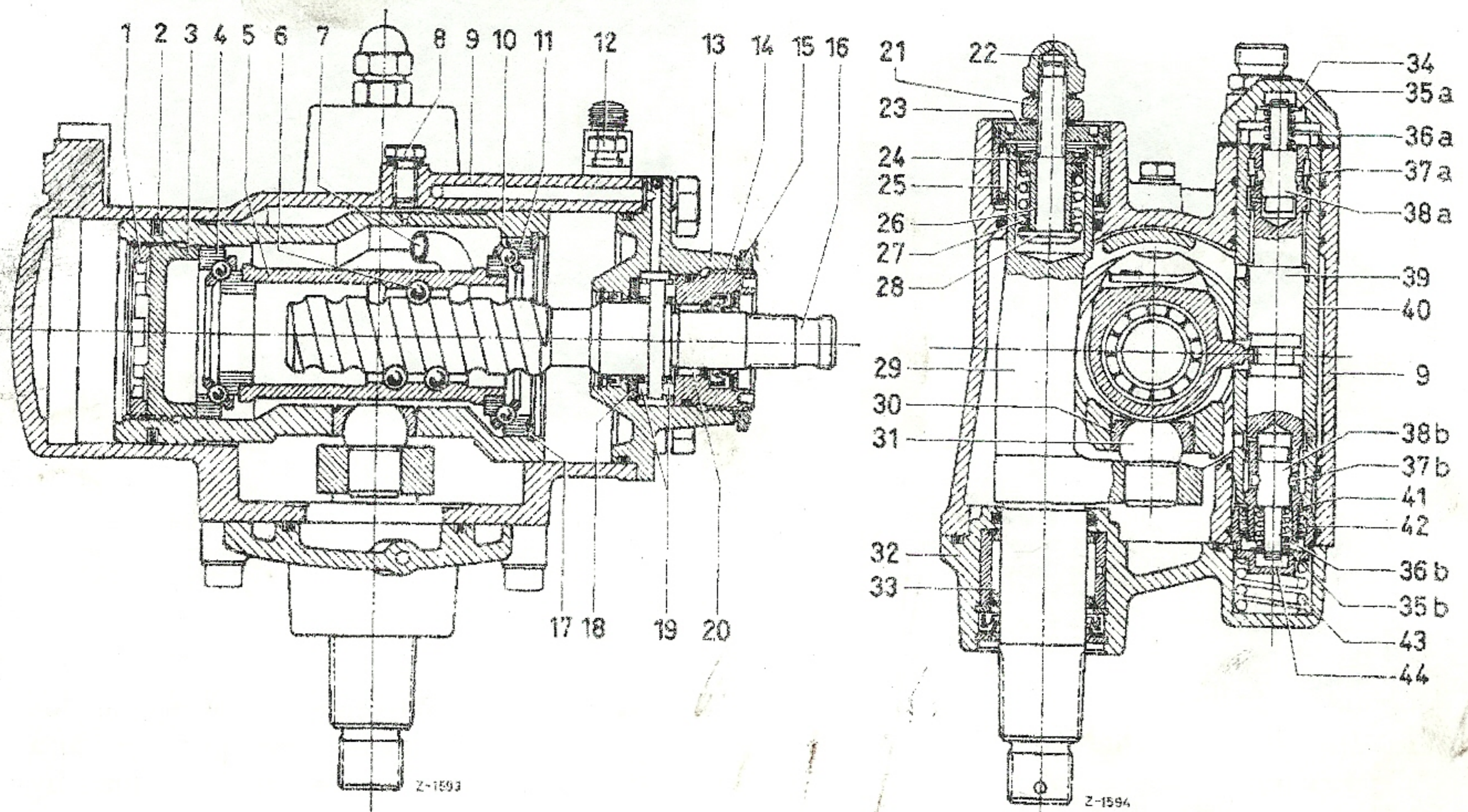

Fig. 46-27/1

- | | | |
|----------------------------------|--------------------------------|---------------------------|
| 1 Threaded ring | 17 Snap ring | 33 Needle bearing |
| 2 Teflon sealing ring | 18 Thrust washer | 34 Upper housing cover |
| 3 Screw cover | 19 Axial bearing | 35a Thrust washer |
| 4 Axial angular contact bearing | 20 Needle bearing | 35b Thrust washer |
| 5 Steering nut | 21 Hexagon nut | 36a Pressure spring |
| 6 Ball | 22 Cap nut | 36b Pressure spring |
| 7 Ball guide tube | 23 Round nut | 37a Dowel pin |
| 8 Screw plug | 24 Thrust washer | 37b Dowel pin |
| 9 Steering housing | 25 Needle bearing | 38a Upper reaction piston |
| 10 Power piston | 26 Pressure sleeve | 38b Lower reaction piston |
| 11 Axial angular contact bearing | 27 Pressure spring | 39 Control slide valve |
| 12 Bleed screw | 28 Adjusting screw | 40 Bushing |
| 13 Bearing cap | 29 Steering shaft | 41 Thrust washer |
| 14 Bearing insert | 30 Ball socket in power piston | 42 Centering spring |
| 15 Hexagon nut | 31 Ball pin | 43 Pressure spring |
| 16 Steering worm | 32 Housing cover | 44 Cover |